

# FAA L-807 & L-807(L) WC Series Rigid Wind Cones

## Compliance and Applications

- ETL Certified L-807 & L-807(L): FAA AC 150/5345-27F
- ICAO Compliant to Annex 14, Vol. 1, para. 5.1.1 (Size 2)

L-807 wind cones provide visual indication of wind direction and velocity for pilots on airfields, heliports and vertiports. FAA Size 2 wind cones are used at the central location on the airfield. FAA Size 1 wind cones are used on smaller airfields and heliports.

## Features

- Primary wind cone for airports, heliports and vertiports
- Pre-assembled bearings and one-piece welded aluminum basket for easy installation
- Center-hinged pole with easy-to-use winch for lowering basket
- Anchor cage for concrete footing included
- Available externally lighted, internally lighted, or unlighted
- 50,000 to 100,000 hour LED lamp life, virtually maintenance free
- LED lamps consume 80-90% less power than halogen lamps
- Night Vision Goggle (NVG) compatible obstruction light
- Solar Power Supply Option available; no more long underground wire and conduit installations
- Wind sock included, (berry compliant ) treated for rot, mildew, and water repellent
- FAA Size 1 (18" dia. x 8') or FAA Size 2 (36" dia. x 12') sock
- Marine Treated Option (recommended for installations within 100 miles of saltwater) available for increased useful life in corrosive environments
- Powder coat painted international orange
- 4 year warranty on LED lamps, 2 year warranty on wind cone
- Designed to operate at any ambient temperature between -67°F (-55°C) and +131°F (+55°C)
- Designed to withstand winds up to 75 knots (86 mph or 140 km/hr)
- Windsock moves freely about the vertical shaft it is attached to when subjected to wind of 3 knots (3.5 mph or 5.6 km/hr) or more and indicates the true wind direction within  $\pm 5^\circ$
- Windsock extends fully when subjected to wind of 15 knots (17.8 mph or 28.7 km/hr)



Intertek



External LED Light



Internal LED Light



Solar Power Supply (SPS) Option

A self-contained photovoltaic power source is now available for WC Series wind cones (see page 4 for details).

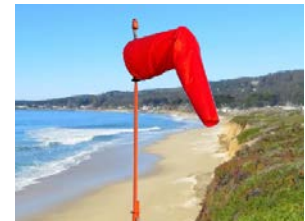

Marine Treated Option

Recommended for high salt and other corrosive environments. Includes: marine treated powder coat, stainless steel bearings, hardware, winch and anchor cage.



## Ordering Codes<sup>1</sup>

FAA Type	FAA Size	FAA Style	Power Source	Options
<b>WC-807</b>	<b>1:</b> Size 1 <b>2:</b> Size 2	<b>EX:</b> Externally Lighted <b>IN:</b> Internally Lighted <b>UN:</b> Unlighted	<b>120:</b> 120 VAC <b>230:</b> 230 VAC <sup>2</sup> <b>66A:</b> 6.6 A <sup>3</sup> <b>12:</b> 12 VDC <sup>4</sup> <b>NON:</b> None (unlighted)	<b>MT:</b> Marine Treated <b>RW:</b> Red/White Steel Pole & Sock

<sup>1</sup> Wind cone includes powder-coated orange steel center-hinged pole, anchor cage, orange wind sock, and obstruction light. Typical lead time: ~3 weeks ARO.

<sup>2</sup> 230 VAC configurations are not ETL certified.

<sup>3</sup> 6.6A configuration requires a 100 W L-830 isolation transformer; Size 2 internally lighted configuration requires a 200 W L-830 transformer (sold separately).

<sup>4</sup> 12 VDC configuration designed for use with Solar Power Supply or 12 VDC driver (sold separately).

## Specifications

Catalog Number	FAA Size	FAA Style	Power Source	Fixture VA	Fixture Watts	Weight (lb.)	Replacement Lamp
<b>UNLIGHTED</b>							
WC-807-1-UN-NON	1	II Unlighted	None	0	0	187	None
WC-807-2-UN-NON	2	II Unlighted	None	0	0	187	None
<b>EXTERNALLY LIGHTED</b>							
WC-807-1-EX-120	1	I-A External	108-132 VAC	15	14	198	9200-0032
WC-807-1-EX-230	1	I-A External	207-253 VAC	15	14	198	9200-0044
WC-807-1-EX-66A	1	I-A External	2.8-6.6 AMP	58	52	197	9200-0034
WC-807-1-EX-12	1	I-A External	11.5-13 VDC	6	6	197	9200-0033
WC-807-2-EX-120	2	I-A External	108-132 VAC	22	21	210	9200-0035
WC-807-2-EX-230	2	I-A External	207-253 VAC	22	21	210	9200-0043
WC-807-2-EX-66A	2	I-A External	2.8-6.6 AMP	58	52	209	9200-0037
WC-807-2-EX-12	2	I-A External	11.5-13 VDC	10	10	210	9200-0036
<b>INTERNALLY LIGHTED</b>							
WC-807-1-IN-120	1	I-B Internal	108-132 VAC	32	19	200	9200-0038
WC-807-1-IN-230	1	I-B Internal	198-265 VAC	40	21	200	9200-0045
WC-807-1-IN-66A	1	I-B Internal	2.8-6.6 AMP	72	65	198	9200-0039
WC-807-1-IN-12	1	I-B Internal	11.5-13 VDC	6	6	197	9200-0041
WC-807-2-IN-120	2	I-B Internal	108-132 VAC	60	32	212	9200-0040
WC-807-2-IN-230	2	I-B Internal	198-265 VAC	76	36	212	9200-0046
WC-807-2-IN-66A	2	I-B Internal	2.8-6.6 AMP	95	88	210	9200-0031
WC-807-2-IN-12	2	I-B Internal	11.5-13 VDC	10	10	210	9200-0042

Power consumption specifications include the L-810 obstruction light.

## Accessories

Part Number	Description
WS-AS1896	Spare Size 1 Wind Sock (18" dia. x 8'), Orange
WS-AS3612	Spare Size 2 Wind Sock (36" dia. x 12'), Orange
WC-SPS*	Solar Power Supply for 12V wind cone models (see page 4 for details)

\* Each SPS is custom configured for the proper solar panel, battery, temperature compensation and height for the installation location. Please contact Flight Light to configure the correct model for your location.

## Shipping Information

- Unpackaged Weight: 187-212 lb.
- Palletized Volume: 72" x 48" x 42"
- Palletized Weight: 350 lb. (fully crated option 500 lb.)



Included  
Anchor Cage



Optional Spare  
Windsock

Optional Solar  
Power Supply

+1.800.806.3548 USA  
+1.916.394.2800 Worldwide

[www.flightlight.com](http://www.flightlight.com)  
[sales@flightlight.com](mailto:sales@flightlight.com)

Flight Light Inc., 2708 47th Ave.  
Sacramento, CA, 95822, USA

**Dimensions**

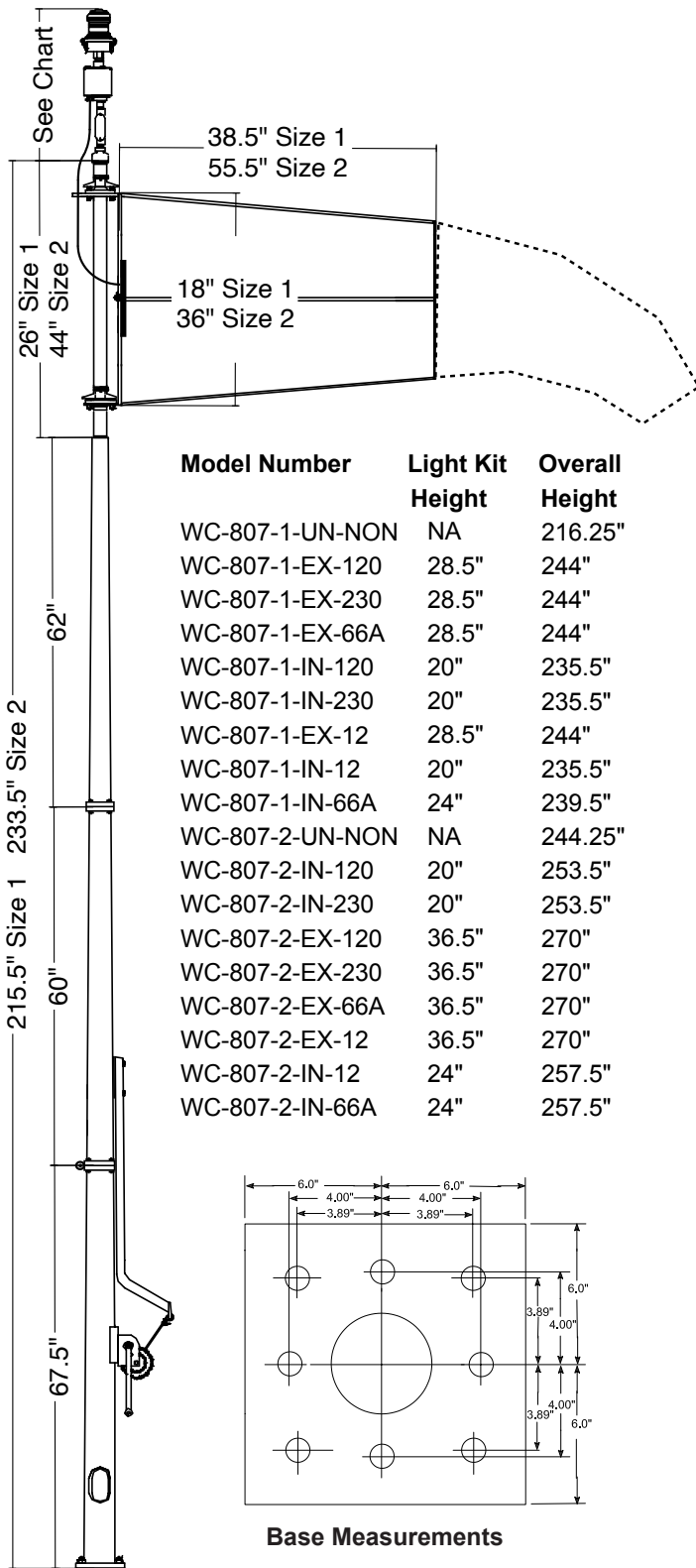

Model Number	Light Kit Height	Overall Height
WC-807-1-UN-NON	NA	216.25"
WC-807-1-EX-120	28.5"	244"
WC-807-1-EX-230	28.5"	244"
WC-807-1-EX-66A	28.5"	244"
WC-807-1-IN-120	20"	235.5"
WC-807-1-IN-230	20"	235.5"
WC-807-1-EX-12	28.5"	244"
WC-807-1-IN-12	20"	235.5"
WC-807-1-IN-66A	24"	239.5"
WC-807-2-UN-NON	NA	244.25"
WC-807-2-IN-120	20"	253.5"
WC-807-2-IN-230	20"	253.5"
WC-807-2-EX-120	36.5"	270"
WC-807-2-EX-230	36.5"	270"
WC-807-2-EX-66A	36.5"	270"
WC-807-2-EX-12	36.5"	270"
WC-807-2-IN-12	24"	257.5"
WC-807-2-IN-66A	24"	257.5"

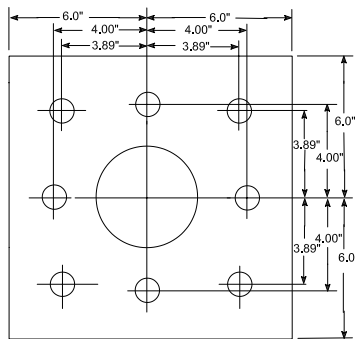

**Base Measurements**

**Anchor Cage & Footing**

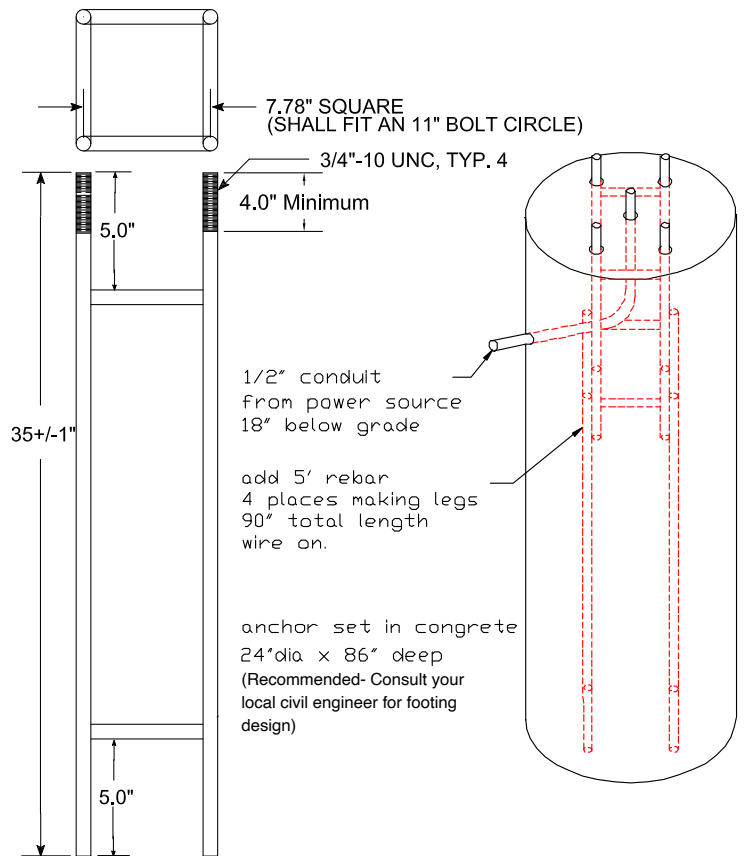

**L807 Base Reactions:**

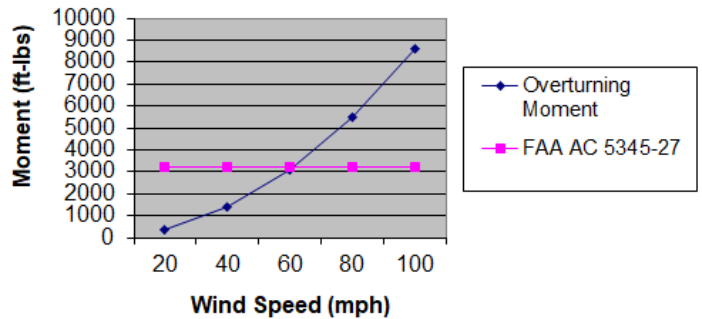

Wind Speed	Overturning Moment	FAA AC 5345-27
20	352	3200
40	1371	3200
60	3087	3200
80	5500	3200
100	8586	3200

# WC Series Wind Cone Solar Power Supply

## Applications

The Solar Power Supply (SPS) is a self-contained photovoltaic power source for the WC Series L-806 and L-807 wind cones.

## Features

- Eliminates expensive underground trenching and wire installations for wind cones
- Easy installation: pre-set solar angle, pre-assembled anchor for easy mounting
- Fully sunlight powered, zero energy cost operation
- 10 day nominal battery autonomy
- Long life premium AGM solar batteries (5-10 years expectancy)
- 100 to 300 A-H AGM battery, designed for 4000 charge/discharge cycles
- 100 or 200 watt solar panel, with 12-year/90% and 25-year/80% power warranty
- Custom designed for the installation site, using 30-year worst case insolation and temperature extremes
- Insulated battery compartment to preserve battery life
- MPPT charge controller, with custom-programmed temperature compensation
- On-board indicators for battery, charging and system status
- Dual-post mount, with frangible couplings, designed to withstand ASCE Exposure C wind loads
- Temperature range: -49 to +131 °F (-45 to +55 °C)
- Marine treated option available for corrosive environments (upgrades enclosure to aluminum, stainless hardware throughout, marine treated powder coat)
- Manufactured in the USA

## Installation Information

The SPS is attached to a 4-bolt anchor assembly (included), mounted in a concrete slab. Power is supplied to the wind cone by a cable in liquid-tight conduit through one of the SPS mounting legs.

## Ordering Information

Product	Description
WC-SPS-100-2-12	100 Watt Panel, 2 Batteries, 12" Legs
WC-SPS-100-2-30	100 Watt Panel, 2 Batteries, 30" Legs
WC-SPS-200-2-12	200 Watt Panel, 2 Batteries, 12" Legs
WC-SPS-200-2-30	200 Watt Panel, 2 Batteries, 30" Legs
WC-SPS MARINE	Marine treated option for installations within 100 miles of the sea. Aluminum enclosure, marine treated powder coat, stainless steel hardware throughout.

NOTE: Each SPS is custom configured for the proper solar panel, battery, temperature compensation and height for the installation location. Please contact Flight Light to configure the correct model for your location.



WC-SPS



200W Panel 59.2" x 26.5"

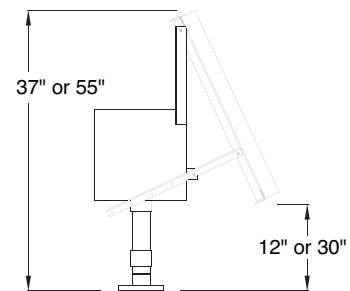
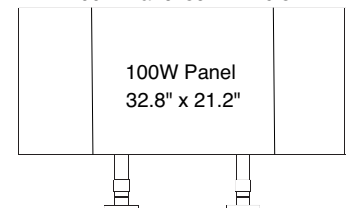

Anchor Assembly Top View

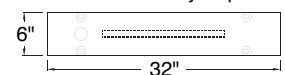

## Replacement Parts

Part #	Description
WC-7800-0004	Solar Panel, 100 Watt
WC-7800-0005	Solar Panel, 200 Watt
WC-1300-0081	Battery, PVX-840T
WC-4500-0020	Charge Controller
WC-7800-0006	Photocell
WC-1800-0036	Frangible Coupling
WC-2300-0024	Fuse, 10A 32V

## Shipping Information

- Unpackaged Weight: 186-268 lb.
  - Shipping Weight: 266-388 lb.
  - International Shipping Weight: 466-588 lb.
  - Shipping Volume: 60" L x 40" W x 44" H
- Can be shipped with wind cone in same crate.