



# L-810 Solar-Powered Obstruction Light

## Applications

The L-810 Solar-Powered Obstruction Light provides reliable obstruction lighting for remote locations where running electrical infrastructure would be costly or impractical. The all-in-one solar system combines a high-capacity lithium-ion battery, efficient solar panel, and durable housing into a fully self-contained unit. Available in single or dual light configurations, the system provides dependable dusk-to-dawn or 24/7 operation and up to seven days of autonomy on a full charge.

## Features

- 100% solar-powered L-810 LED obstruction light - eliminates the cost and complexity of running electrical power to remote locations
- Includes L-810 omni-directional, red, steady-burning, LED obstruction light
- Available in single or dual obstruction light configurations
- Automatic photocell for "dusk to dawn" operation
- Option for 24/7 "always on" mode
- 50 Ah lithium-ion battery for long life and extended runtime
- 50-watt solar panel ensures operation in sunny or cloudy climates
- 7-day autonomy: runs for 7+ days without sun on a fully charged battery (single light, dusk to dawn)
- Adjustable solar panel angle based on location
- Powder-coated housing for superior environmental protection
- Perfect for fences, posts, buildings, or any other obstructions that are difficult to run power to
- Universal fence mount plate accommodates up to a 3.5" post (U-bolts to fence not included)
- Easy installation: mount plate and post to fence first, then slip on pre-assembled housing and panel
- Optional wall or roof mount hardware available

## Shipping Information

- Main enclosure, battery, and light: 48.2 lb.
- Fence mount hardware and post: 10.2 lb.
- Shipping weight: 60 lb.
- Shipping dimensions: 36" x 24" x 20"



## Ordering Codes

System	Output Color	Fixture Power	Fixture Style	Fixture Mounting	Options
FL-S810L <sup>1</sup>	NVR: Red + Infrared (IR) <sup>2</sup> R: Red	DC: 12-48 VDC	S: Single D: Double	34B: 3/4" Hub - Bottom	100C: 100 Candelas Fixture H: High Temperature Fixture <sup>3</sup> MT: Marine Treated Fixture RM: System Roof Mount Hardware WM: System Wall Mount Hardware

<sup>1</sup> System includes FL-810L fixture, solar panel, housing, battery, charge controller, photocell and universal fence post mount. <sup>2</sup> Only fixtures with NVR output color (Red + IR) are FAA approved. All other output colors and system components are not FAA approved. <sup>3</sup> For locations with high temperatures above +131°F (+55°C). Not FAA approved.

+1.800.806.3548 USA  
+1.916.394.2800 Worldwide

[www.flightlight.com](http://www.flightlight.com)  
[sales@flightlight.com](mailto:sales@flightlight.com)

Flight Light Inc., 2708 47th Ave.  
Sacramento, CA, 95822, USA



## Mounting Configurations

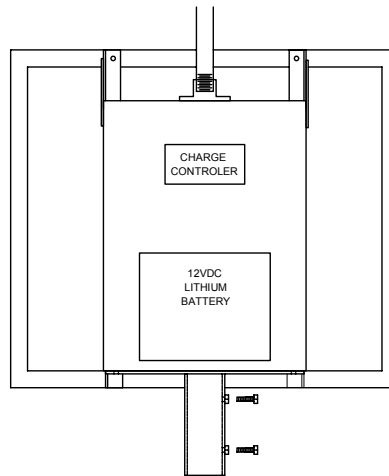

DIRECT POST MOUNT

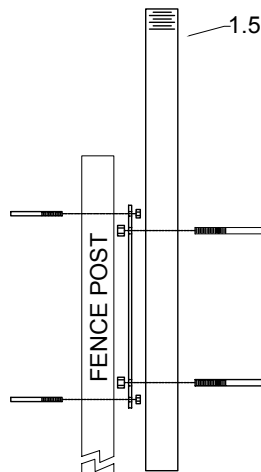

POST TO  
POST MOUNT

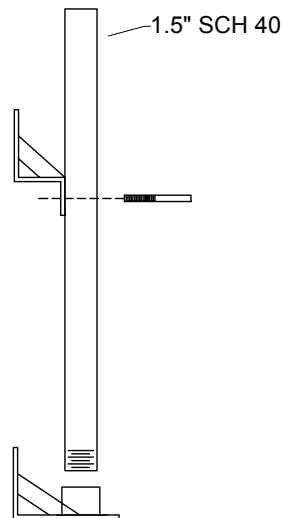

WALL MOUNT

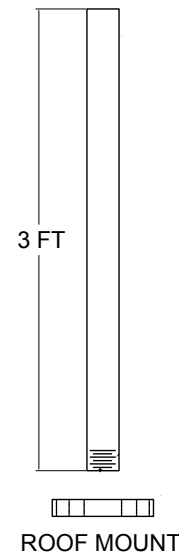

ROOF MOUNT